

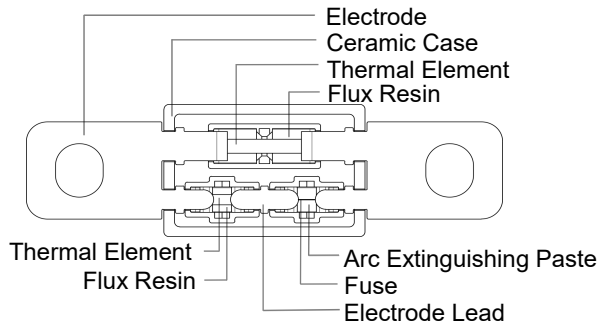

Description

DC Alloy Thermal-Link is defined as a Non-Resettable protective device functioning one time only. It is widely used in electrical equipment and electric vehicle. Normally, thermal element and fuse is jointed in parallel to the two electrode leads. Under abnormal conditions, when the temp. reaches to the fusing temp. of Thermal-Link, the thermal element melts and quickly retracts to the two electrode lead ends with the aid of the flux, then fuse melts to disconnect the circuit completely.

Structure Diagrams



Features

- 0 to 500 VDC Operating Voltage
- High Accuracy of Functioning Temp.
- Ceramic Case
- Non-Resettable
- RoHS & REACH Compliant

Applications

- Battery Cooling Systems
- Precharged Resistors
- Automotive Air-Conditioners
- Heaters

Product Schematic

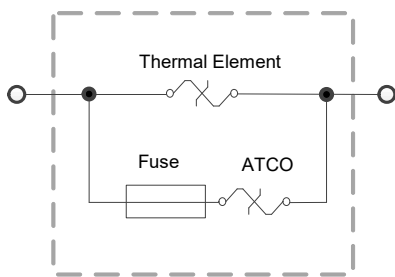

Customization

- Rated Functioning Temp.
- The Shape of Electrode Leads

Agency Approvals

Agency Mark	Standards	File No.
	UL60691	Ongoing
	CAN-CSA-E60691	Ongoing
	EN60691	Ongoing
	EN60691	Ongoing
	GB9816	Ongoing

Marking

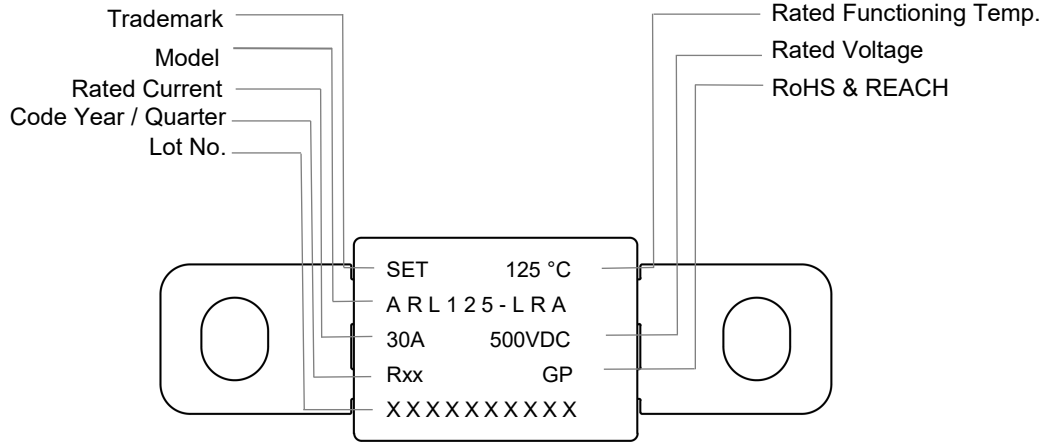

Part Numbering System

DC-ATCO - ARL125 - LR A

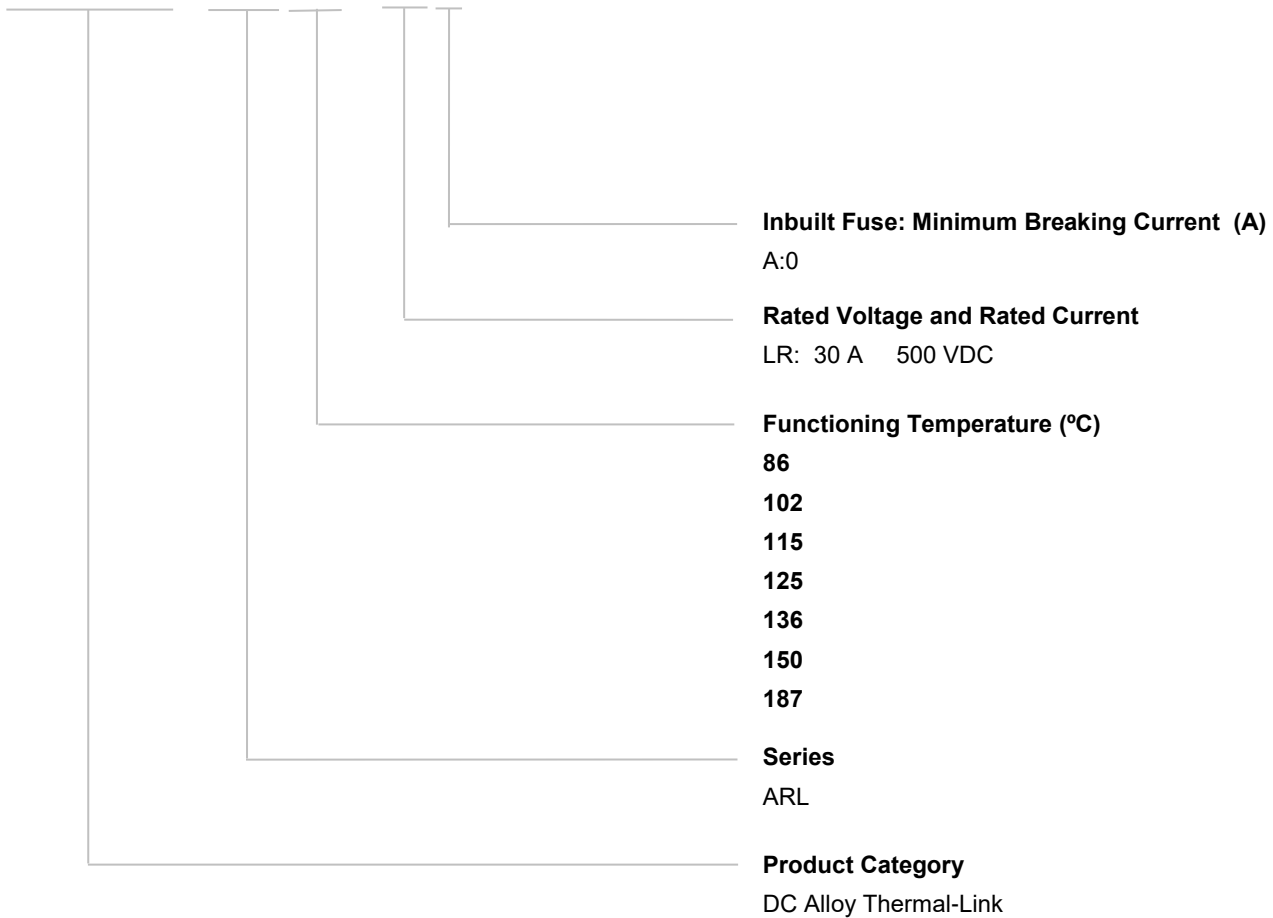

ATCO

ATCO

Glossary

Item	Description
TCO	Thermal-Link A non-resettable device incorporating a THERMAL ELEMENT which will open a circuit once only when exposed for a sufficient length of time to a temperature in excess of that for which it has been designed.
ATCO	Alloy Thermal-Link Alloy Type Thermal-Link, Alloy is the thermal element.
DC-ATCO	DC-Alloy Thermal-Link Direct Current Alloy Thermal-Link.
T_f	Rated Functioning Temp. The temperature of the Thermal-Link which causes it to change the state of conductivity with a detection current up to 10 mA as the only load. Tolerance: $T_f +0 / -10$ °C (GB 9816, EN 60691, K60691). Tolerance: $T_f \pm 7$ °C (J60691).
Fusing Temp.	The temperature of the Thermal-Link which causes it to change its state of conductivity is measured with silicone oil bath in which the temperature is increased at the rate of 0.5 °C to 1 °C / minute, with a detection current up to 10 mA as the only load.
T_h	Holding Temp. The Maximum temperature at which a Thermal-Link will not change its state of conductivity when conducting rated current for 168 hours.
T_m	Maximum Temp. Limit The temperature of the Thermal-Link stated by the manufacturer, up to which the mechanical and electrical properties of the Thermal-Link having changed its state of conductivity, will not be impaired for a given time.
I_{min}	Minimum Breaking Current The minimum current that Fuse requires after the Alloy of Thermal-Link opens in the circuit.
I_r	Rated Current The current used to classify a Thermal-Link, which is the maximum current that Thermal-Link allows to carry and is able to cut off the circuit safely.
U_r	Rated Voltage The voltage used to classify a Thermal-Link, which is the maximum voltage that Thermal-link allows to carry and is able to cut off the circuit safely.

ATCO



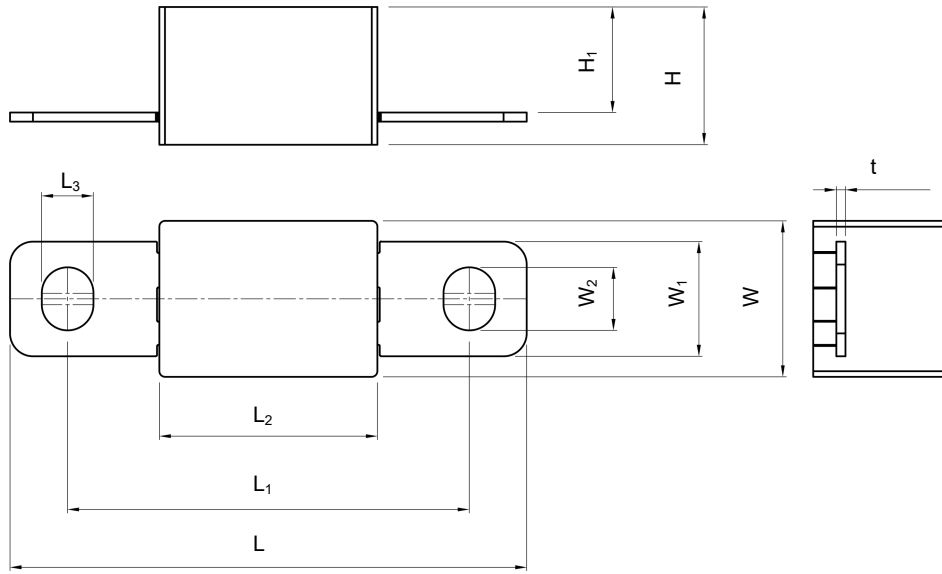

ATCO

Dimensions (mm)



L	L ₁	L ₂	L ₃	W	W ₁	W ₂	H	H ₁	t
45.0 ± 1.0	35.0 ± 1.0	19.0 ± 1.0	4.5 ± 0.2	13.6 ± 1.0	10.00 ± 0.05	5.5 ± 0.2	12.0 ± 0.8	9.2 ± 0.8	0.80 ± 0.05

Specifications

Model	T_f	Fusing Temp.	T_h	T_m	I_{min}	I_r	U_r						RoHS REACH
	(°C)	(°C)	(°C)	(°C)	(A)	(A)	(V)	UL	CUL	TUV	VDE	CCC	
ARL86-LRA	86	83 ± 2	45	250	0	30	DC 500						●
ARL102-LRA	102	99 ± 2	75	250	0	30	DC 500						●
ARL115-LRA	115	111 ± 2	75	250	0	30	DC 500						●
ARL125-LRA	125	121 ± 2	85	250	0	30	DC 500						●
ARL136-LRA	135	131 ± 2	80	250	0	30	DC 500						●
ARL150-LRA	150	146 ± 2	120	250	0	30	DC 500						●
ARL187-LRA	187	184 ± 2	125	250	0	30	DC 500						●

Temp.-Time Curve

The functioning temperature time curve of Alloy Thermal-Link in different Temp. oil bath. (This curve is for reference only)

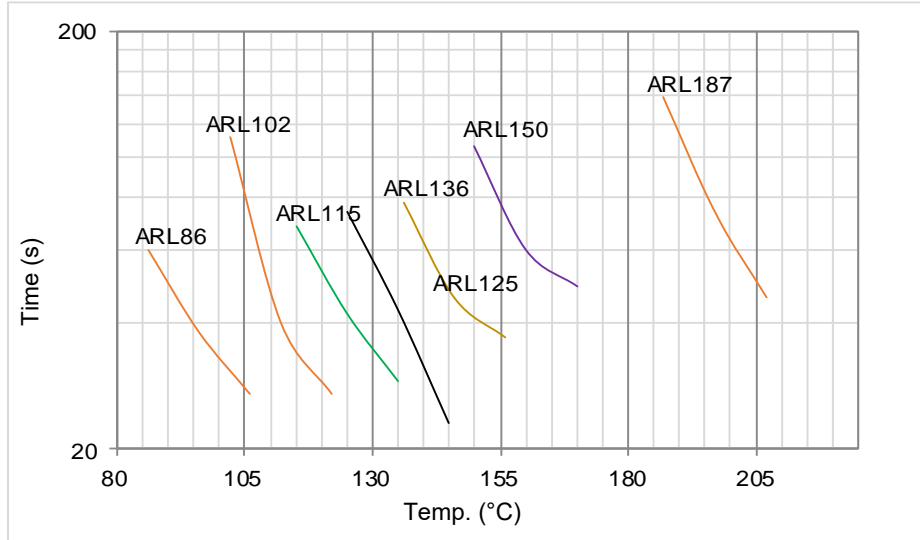

Current-Time Curve

This is an illustrated curve, describing the opening time at Multi-times rated current in the condition of the room Temp. 25 °C. (This curve is for reference only)

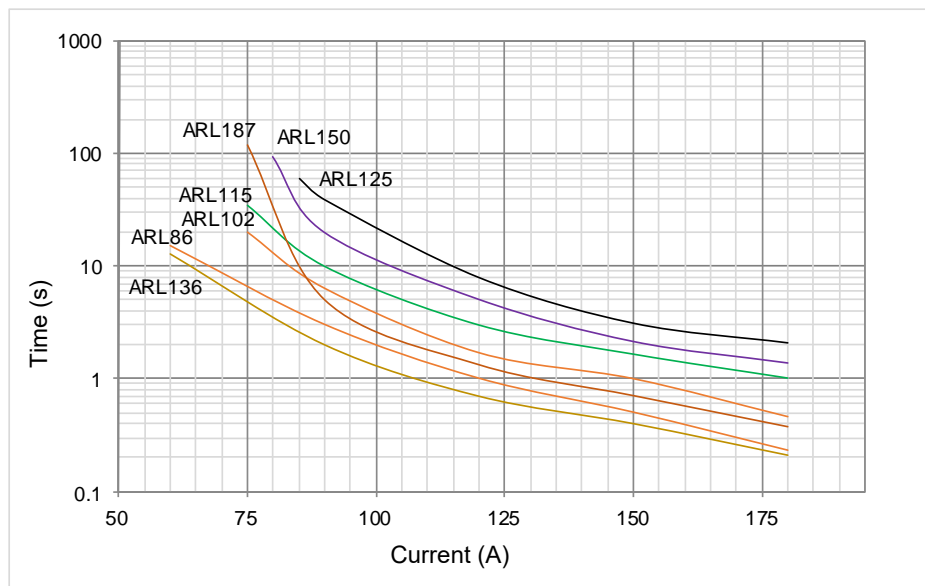



ATTENTION

Usage

1. When atmosphere pressure is from 80 kPa to 106 kPa, the related altitude shall be from +2000 m to - 500 m.
2. Operating voltage less than rated voltage of DC-ATCO, operating current less than rated current of DC-ATCO.
3. Do not touch the DC-ATCO body or lead wires directly when power is on, to avoid burn or electric shock.

Replace

DC-ATCO is a non-repairable product. For safety sake, it shall be replaced by an equivalent DC-ATCO from the same manufacturer, and mounted in the same way.

Storage

Do not store the DC-ATCO at the high temp., high humidity or corrosive gas environment. The product shall be stored at 25 ± 5 °C and $\leq 70\%$ RH, avoid direct sunlight and shall use them up within 1 year after receiving the goods.

Installation

Make Sure the Installation Position be close to the heat source.

1. It is recommended that a dummy DC-ATCO with inbuilt thermo-couple shall be used to determine the proper temperature.
2. The terminal product should be tested to ensure that potential abnormal conditions do not cause ambient temp. to exceed the T_m of the DC-ATCO.
3. Mount the DC-ATCO at the location where Temp. rises evenly.

Installation position of mechanical performance requirements.

1. Ensure that the electrode lead is long enough, and avoid actions such as press, tensile or twist.
2. The seal or body of DC-ATCO must not be damaged, burned or over heated.

Electrical Connections**Mechanical Connection**

1. The product surface must not be damaged.
2. Please select flexible lead wires to connect our products, because expansion or contraction may cause mechanical stress.
3. Please make sure the electrode without grease or other foreign matters, and use the same cross-section connection wire, otherwise the electrode may heat abnormally.
4. To prevent loosening, please add gasket and use proper screw when installing the product. Make sure the torque be controlled within (3 to 4) N · m

Packaging Information

Item	Tray	PE Bag	Carton
Dimensions (mm)	290 x 215 x 20	290 x 215 x 60	455 x 315 x 285
Quantity (PCS)	50	100	800
Gross Weight (kg):			20 ± 10%

ATCO

ATCO

